



Self-Clinching Flush Nuts

Series CFL



CFL flush nuts offer the advantage of being completely flush within the sheet while providing load-bearing threads in materials too ductile to tap. Captive Fastener flush nuts fit standard sizes and are otherwise dimensionally identical to industry standards.

Material: 300 Series Stainless Steel.

Finish: Passivated ASTM A380.

Thread: Class 2B, MIL-S-7742; (6H ISO metric).

Use in: Materials with Rockwell Hardness of B-70 or less.

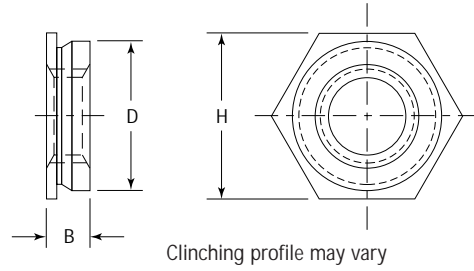

Dimensions & Specifications

Thread Size	Part Number	D Max.	Min.		H Nom.	B Max.	Min.
			Min.	+ .003 in. (.08 mm) - .000			
INCH (in.)	#2-56	.171	.061	.172	.1875	.060	.23
	CFL256-2		.091			.090	
	#4-40	.171	.061	.172	.1875	.060	.23
	CFL440-2		.091			.090	
	#6-32	.212	.061	.213	.25	.060	.27
	CFL632-2		.091			.090	
	#8-32	.289	.061	.290	.3125	.060	.28
	CFL832-2		.091			.090	
	#10-24	.311	.061	.312	.3438	.060	.31
	CFL1024-2		.091			.090	
	#10-32	.311	.061	.312	.3438	.060	.31
	CFL1032-2		.091			.090	
	1/4-20	.343	.126	.344	.375	.120	.34
	CFL420-4		.156				
CFL420-5	.187					.182	
1/4-28	.343	.126	.344	.375	.120	.34	
CFL428-4		.156					.151
CFL428-5		.187					.182
METRIC (mm)	M2 x 0.5	4.34	1.5	4.4	4.8	1.5	6.0
	CFLM2-2		2.3				
	M2.5 x 0.5	4.34	1.5	4.4	4.8	1.5	6.0
	CFLM2.5-2		2.3				
	M3 x 0.5	4.34	1.5	4.4	4.8	1.5	6.0
	CFLM3-2		2.3				
	M3.5 x 0.5	5.35	1.5	5.4	6.4	1.5	6.5
	CFLM3.5-2		2.3				
	M4 x 0.7	7.34	1.5	7.4	7.94	1.5	7.2
	CFLM4-2		2.3				
	M5 x 0.8	7.87	1.5	7.9	8.73	1.5	8.0
	CFLM5-2		2.3				
	M6 x 1.0	8.71	3.2	8.75	9.53	3.1	8.8
	CFLM6-4		4.0				
CFLM6-5	4.75					4.7	

Continued on next page.



Self-Clinching Flush Nuts

Series CFL

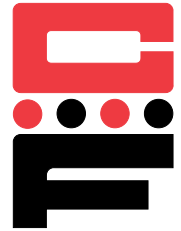

Continued from previous page.

Installation & Performance Data

	Part Number	Max. Screw torque (in.-lbs.)	Cold-rolled Steel		5052-H34 Aluminum	
			Installation Force (tons)	Pushout (lbs.)	Installation Force (tons)	Pushout (lbs.)
INCH (in.)	CFL256-1	1.5	1.5	200	1	200
	CFL256-2	1.5	1.5	200	1	200
	CFL440-1	2.5	1.5	200	1	200
	CFL440-2	2.5	1.5	200	1	200
	CFL632-1	3.5	1.5	200	1	200
	CFL632-2	3.5	1.5	200	1	200
	CFL832-1	5.25	2	240	1	240
	CFL832-2	5.25	2	240	1	240
	CFL1024-1	7.5	2	240	1.5	240
	CFL1024-2	7.5	2	240	1.5	240
	CFL1032-1	7.5	2	240	1.5	240
	CFL1032-2	7.5	2	240	1.5	240
	CFL420-3	20	2.5	840	2	640
	CFL420-4	20	2.5	840	2	640
	CFL420-5	20	2.5	840	2	640
	CFL428-3	20	2.5	840	2	640
	CFL428-4	20	2.5	840	2	640
	CFL428-5	20	2.5	840	2	640
	Part Number	Max. Screw Torque (N·m)	Installation Force (kN)	Pushout (kN)	Installation Force (kN)	Pushout (kN)
METRIC (mm)	CFLM2-1	0.16	13.3	0.9	8.9	0.9
	CFLM2-2	0.16	13.3	0.9	8.9	0.9
	CFLM2.5-1	0.23	13.3	0.9	8.9	0.9
	CFLM2.5-2	0.23	13.3	0.9	8.9	0.9
	CFLM3-1	0.3	10	0.9	8	0.9
	CFLM3.5-1	0.4	12	1.0	9	0.9
	CFLM4-1	0.5	15	1.1	10	1.0
	CFLM5-1	0.8	18	1.1	12	1.1
	CFLM6-3	3.7	20.0	3.7	15	2.8